

Features: Heavy duty ductile iron manhole cover and frame.
Double Triangle Cover
Standard Lifting Keyholes
GRP Sealing Provision
Markings as required in Arabic & English

Material: Spheroidal or nodular iron (ductile iron according to BS EN 1563:1997)

Design Load: Minimum 400KN (approx. 40 tons) according to BS EN 124 Class D400.

Protective Coating: Black Bitumen Coated

PRODUCT CODE	CLEAR OPENING (A)	OVERBASE (B)	DEPTH (C)
MC 600	600 x 600 mm	734 x 734 mm	100 mm
MC 675	675 x 675 mm	787 x 787 mm	100 mm

MC 675

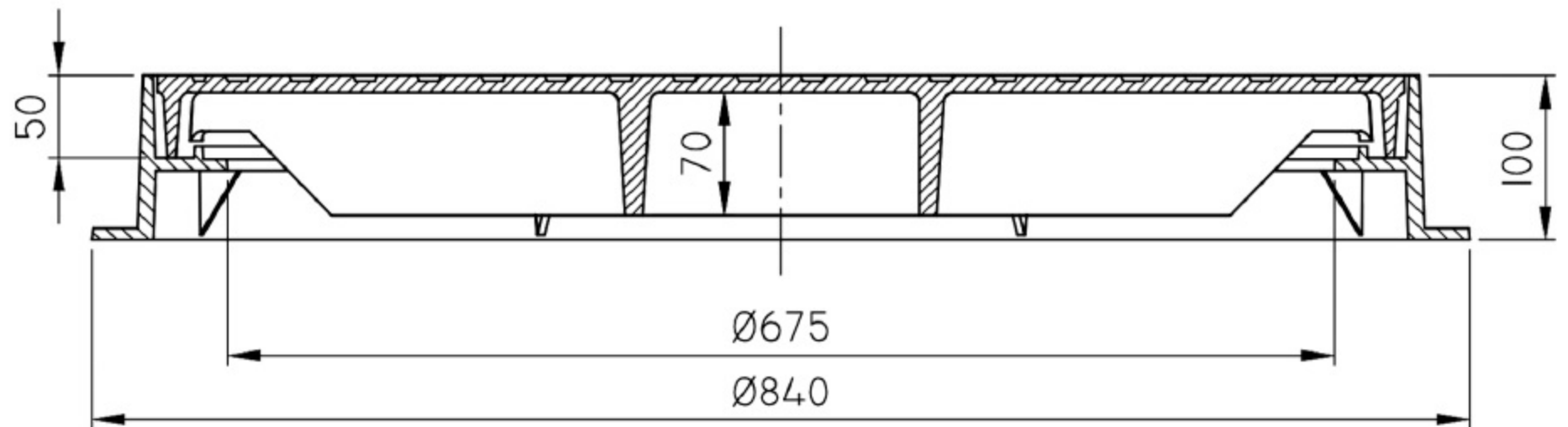
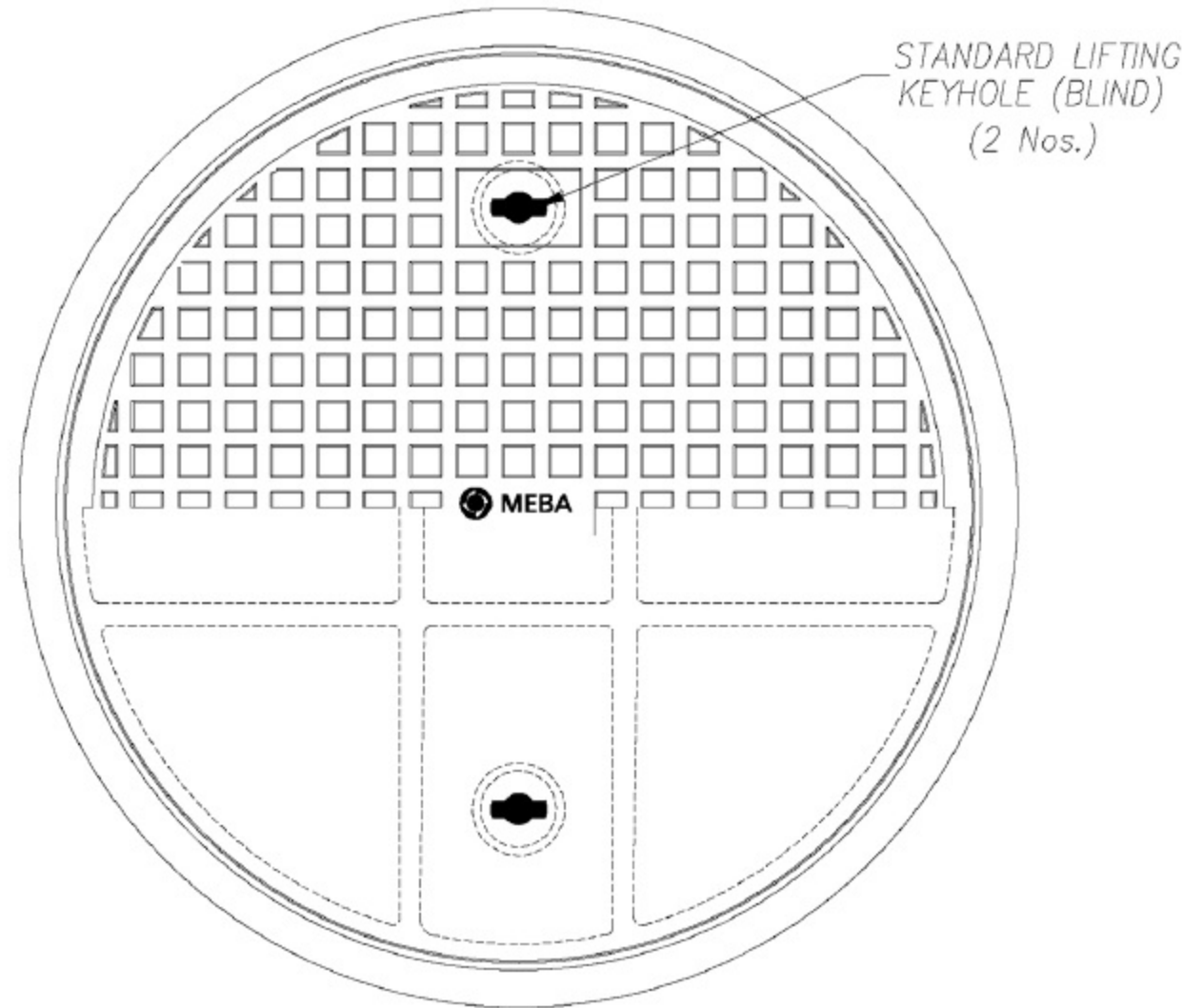

Features: Heavy duty ductile iron manhole cover and frame. Closed keyhole One-way fit coverSingle seal with GRP ProvisionMarkings as required in Arabic & English

Material: Spheroidal or nodular iron (ductile iron according to BS EN 1563:1997)

Dimensions: Clear opening = 675 mm Dia
Overbase = 840 mm
Depth = 100mm

Design Load: Minimum 400KN (approx. 40 tons) according to BS EN 124 Class D400.

Protective Coating: Black Bitumen Coated.

ROAD GULLY GRATING 385 X 315

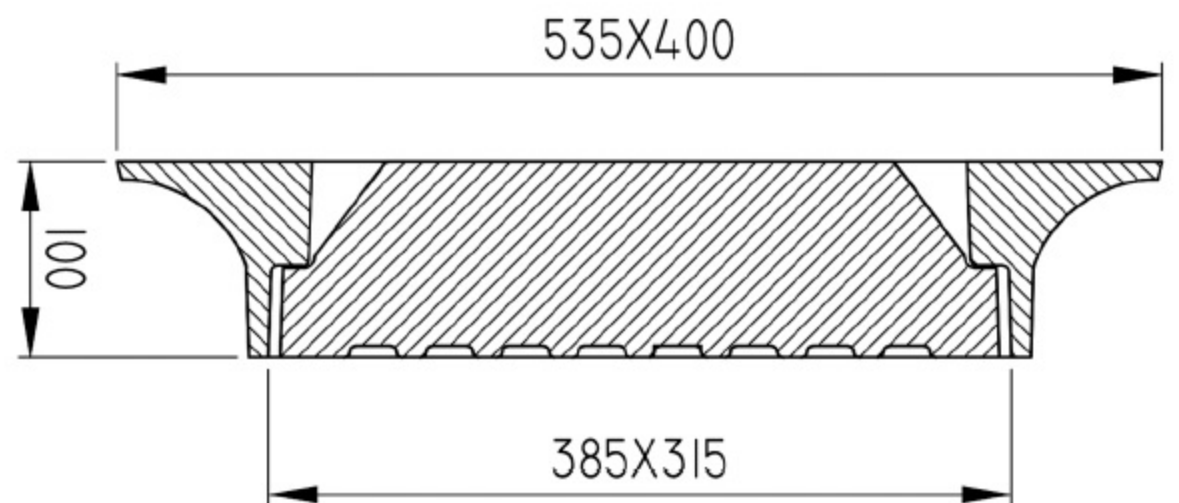
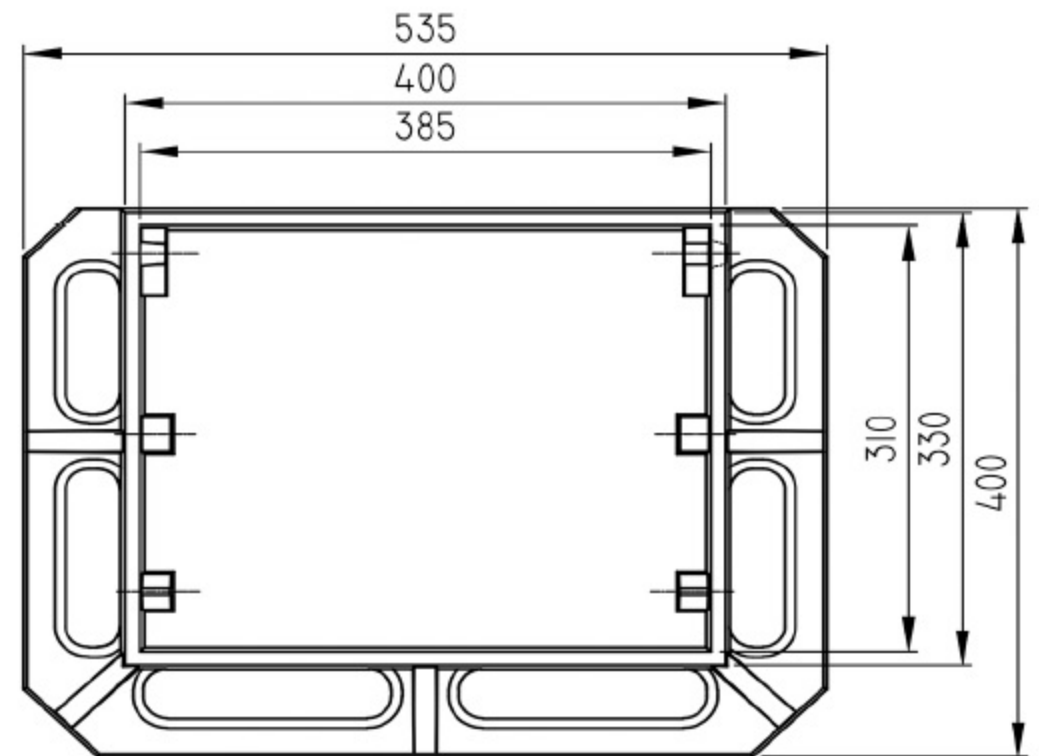

Features: Heavy duty grate and frame

Material: Spheroidal Graphite iron (ductile iron according to BS EN 1563:1997)

Dimensions: Clear opening = 385 x 315 mm
Overbase = 535 x 400 mm
Depth = 100mm

Design Load: Minimum 400KN (approx. 40 tons) according to BS EN 124 Class D400.

Protective Coating: Black Bitumen Coated.

Consultancy & Research Section**Material Compliance Report (MCR) 3488/2019**
(For Ministry of Works projects)

Material Detail:	Manhole Cover & Gully Grating with Frame, Ductile Iron <ul style="list-style-type: none"> Clear Opening 675mm Diameter, Single Seal, GRP Lip, Loading Class D400 Clear Opening 675x675mm, DTR, GRP Lip, Loading Class D400 Clear Opening 600x600mm, DTR, GRP Lip, Loading Class D400 Clear Opening 385x315mm, Loading Class D400
Manufacturer:	Metals of Bahrain Co. W.L.L, (BAHRAIN)
Applicant:	Metals of Bahrain Co. W.L.L P. O. Box 54299 Askar, Kingdom of Bahrain

Following MED standard procedures for assessment and technical evaluations of the above Material, as to compliance with the Ministry of Works' specifications and requirements, we advise as per the following details:

i. Compliance with Relevant Standards & Specifications

Acceptable

ii. Adequacy for use in Ministry of Works projects

Adequate.
The Material is suitable for use in Ministry of Works' projects.

iii. Comments

- The Product when tested should adhere to **BS EN 124: 2015** and shall always conform to the Standard Specifications for Construction Works - 2009 of the MOW projects.
- This compliance report does in no way relieve the supplier or contractor of their obligation with respect to obtaining the necessary approval of the concerned Project Engineer for a specific project.
- The material will be subject to factory inspection and periodic quality control assessment by the Materials Engineering Directorate personnel.

Note:

This Report is valid for maximum of 1 year(s) from the date of this Report **unless otherwise stated** or there is a change / revision in the material technical specifications, manufacturing process or relevant Standards & Specifications requirements.

Signed & stamped by,

Date: 18th November 2019

MAS File 4336/CEMCG



Director, Materials Engineering Directorate